

# TSE Type ULTRA 55V

## BSWF

»System Spengler®«  
»EASI-SET® / J-J Hooks®«



System width = 24 cm

Planning width = 24 cm

T1-W1-A / T3-W2

- Featuring Spengler's proven-and-tried claw connection
- Unimpeded cross-drainage flow
- Ultra-slim and space-saving
- The first slim-system with step-profile
- Integrated reflector in accordance with TL-TS – for more night-time safety
- Outstanding ratings for containment level and working width
- Fully integrated into Spengler's system of precast concrete protection barriers, approval includes transition to double-sided Type NJ 81RV– H1-W4-B barrier as portable protection equipment.



»System Spengler®«  
 »EASI-SET®/J-J Hooks®«

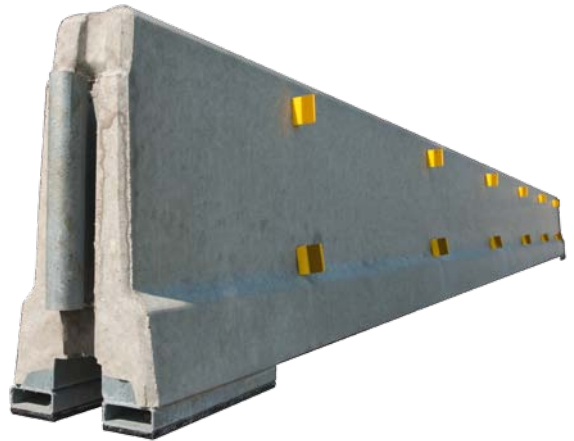
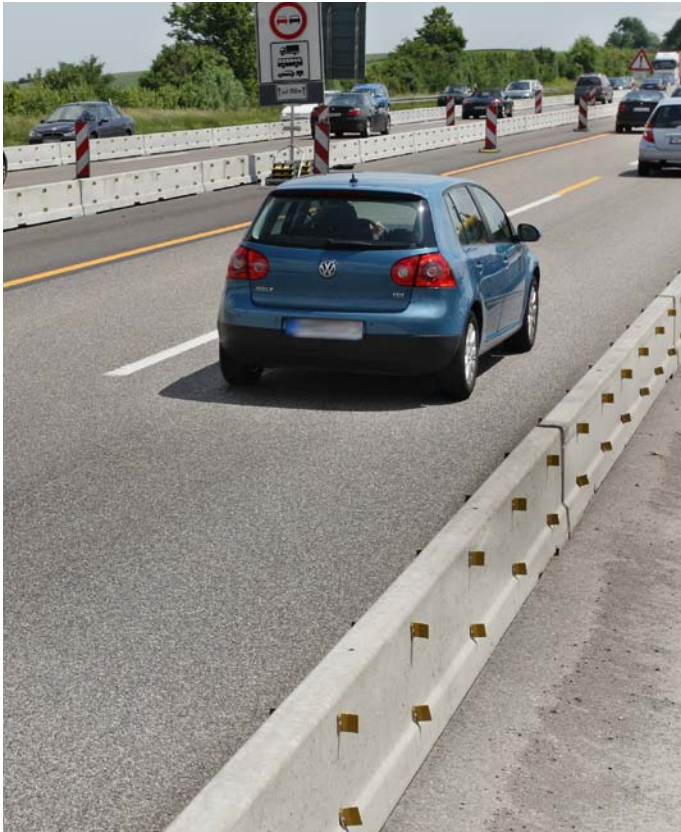

|  |            |       |
|--|------------|-------|
| Tested in accordance with DIN EN 1317          |            |       |
| Test   | TB 21      | TB 41 |
| Containment performance class                  | T1         | T3    |
| Working width                                  | W1         | W2    |
| ASI-value                                      | A          | —     |
| Tested length                                  | 66 m       |       |
| BASf appraisal based on TL-TS                  | 2009 7E 57 |       |
| System dimensions L x B x H = 600 x 24 x 55 cm |            |       |



Hermann Spengler GmbH & Co. KG  
 www.spengler.de • info@spengler.de

Gehrensägmühle 5 • D-73479 Ellwangen • Telephone +49 (0)7961 9088-0 • Fax +49 (0)7961 9088-30  
 Büro West: Postfach 300 162 • D-51503 Rösraih • j.schellhorn@spengler.de  
 Telephone +49 (0)2205 8095-574 • Mobile +49 (0)172 711 61 77

For further information please contact us or our licence partners:



Fritz Herrmann GmbH & Co. KG  
 D-06722 Kleinhelmsdorf  
 D-07619 Nautschütz  
 Telephone +49 (0)36694 40-210  
 Fax +49 (0)36694 40-299  
 info@fritz-herrmann.de  
 www.fritz-herrmann.de



KLOSTERMANN Schutzsysteme  
 GmbH & Co. KG  
 D-48653 Coesfeld  
 Telephone +49 (0)2541 749-77  
 Fax +49 (0)2541 7 49-36  
 info@klostermann-beton.de  
 www.klostermann-beton.de